

ABOARD WIND SURF

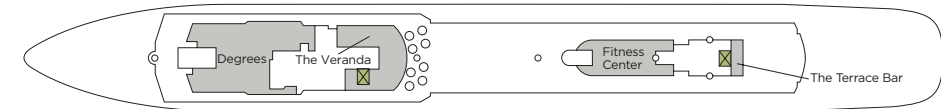

ONBOARD SPACES

- | | | |
|--------------------------------------------|---------------------------------------|-----------------------------|
| 1 The Bridge | 9 The Lounge | 15 WindSpa |
| 2 Degrees Restaurant | 10 Yacht Club Sandwich & Espresso Bar | 16 Signature Shop |
| 3 AmphorA | 11 Fitness Center | 17 Pool/Pool Bar/Whirlpools |
| 4 Bridge Suites | 12 Compass Rose Bar | 18 Watersports Platform |
| 5 Casino | 13 Reception | 19 The Terrace Bar |
| 6 The Veranda | 14 Nautilus Room | 20 Candles Grill |
| 7 Suites and Category AX Deluxe Staterooms | | |
| 8 Staterooms | | |



STAR DECK

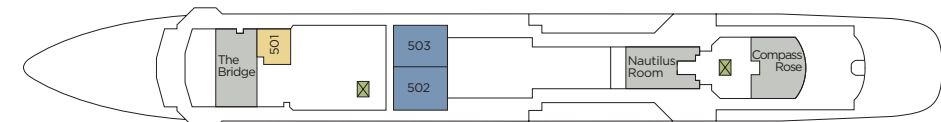

BRIDGE DECK

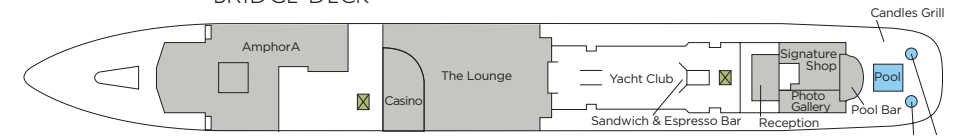

MAIN DECK

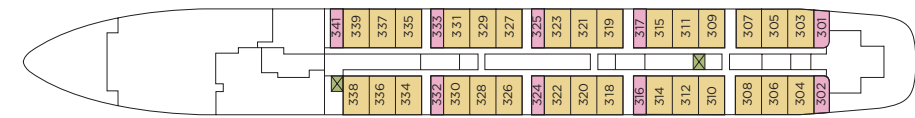

DECK THREE



DECK TWO

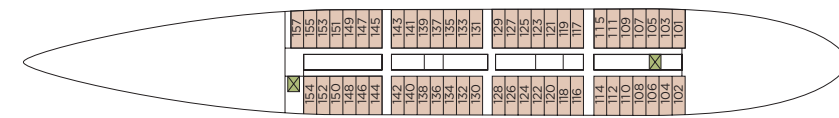

DECK ONE

Wind Surf features 6 guest decks and a total of 22,090 square feet.

- BRIDGE SUITES
- SUITES
- CATEGORY AX DELUXE
- CATEGORY A
- CATEGORY B
- PUBLIC SPACES
- STAIRS/ELEVATOR

MAIN SHEET

LENGTH: 535 feet (162 meters) at waterline; 617 feet (187 meters) including bowsprit

DRAFT: 16.5 feet (5 meters)

TONNAGE: 14,745 gross registered tons (grt)

BEAM: 66 feet (20 meters)

SAILS: 7 triangular, self-furling, bridge-operated sails with 26,881 square feet (or 2,600 square meters) of Dacron surface area

MASTS: 5 at 164 feet (50 meters)

ENGINES: 4 diesel electric generator sets, 2 electrical propulsion motors

SPEED: 10 to 12 knots with engines only; up to 15 knots with prevailing wind

SHIP'S REGISTRY: Bahamas

STATEROOMS & SUITES

Bridge Suites: 495 square feet or 46 square meters

Staterooms: 188 square feet or 18 square meters

Suite 501: 376 square feet or 35 square meters

Staterooms with 3rd Berths: 117-139; all suites (excluding 501)

Suites: 376 square feet or 35 square meters

Rooms with queen beds that convert into (2) twin beds: 103-155; 205-269; 305-339; 501, 502, 503

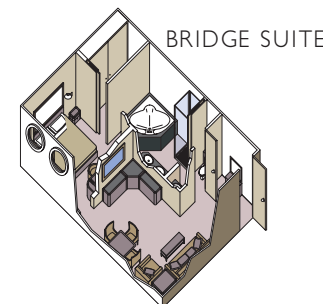

BRIDGE SUITE

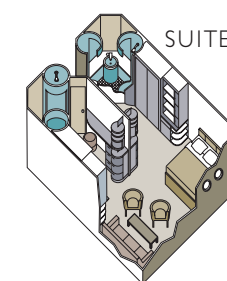

SUITE

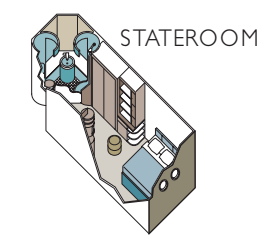

STATEROOM